



MINISTRY OF COMMUNICATIONS, WORKS & LABOUR

P O BOX 344, BRADES, MONTSERRAT, W I

◆ Tel: (664) 491-2521/2522 ◆ Fax: (664) 491-6659 ◆ E-mail: mew@gov.ms

November 24th, 2017

Dear Sir/Madam,

ADDENDUM No. 1 – Clarification and update to Bill of Quantities

Re: Tender for Construction of Reinforced Masonry Retaining Wall in Barzeys – Section 1 - 3

Please note below the addendum to the Bill of Quantities for the Tender for the Construction of Reinforced Masonry Retaining Wall in Barzey's River Section 1-3 under the Infrastructure Priority Project, issued on November 9th 2017. Similarly, the site plan for the area is attached. Section 1-3 is represented as Section A-B

Original

3.01 - Construct reinforced masonry retaining wall in compliance with drawing details provided on Sheet No. S-01: 8'-0" height by 3'-2" wide base. Also include for 8" x 8" column stiffeners reinforced with 5/8" vertical bars and 3/8" tensile links @ 8" crs (See Sheet No.02). Columns shall be placed at every 10'-0" intervals and shall finish with 8" x 4" cap beam reinforced with No.66 BRC fabric (See Sheet No.02) with vertical bars from the wall and columns extending 2" into the capping beam. In compliance with drawing details, hollow concrete block shall be reinforced with 1/2" vertical bar to every core and concrete filled; provide lateral mesh reinforcement to every second block course which must tie into columns at the minimum 4" on each side. Also include for constructing bends or curves within masonry retaining wall.

Update

3.01 - Construct reinforced masonry retaining wall in compliance with drawing details provided on Sheet No. S-01: 8'-0" height by 3'-2" wide base. Also include for 8" x 8" column stiffeners reinforced with 5/8" vertical bars and 3/8" tensile links @ 8" crs (See Sheet No.02). Columns shall be placed at every 10'-0" intervals and shall finish with 8" x 4" cap beam reinforced with No.66 BRC fabric (See Sheet No.02) with vertical bars from the wall and columns extending 2" into the capping beam. In compliance with drawing details, hollow concrete block shall be reinforced with 1/2" vertical bar to every **other** core and concrete filled; provide lateral mesh reinforcement to every **third** block course which must tie into columns at the minimum 4" on each side. Also include for constructing bends or curves within masonry retaining wall. Include for 4" diameter weepers staggered every 5ft.

All queries and clarification relating to this tender should be sent to Mr. Rawlson Patterson, Civil Engineer at pattersonr@gov.ms.

Best Regards

Beverly Mendes
Chairperson
Departmental Tender Committee
Ministry of Communications, Works & Labour

BEM/gf

GENERAL NOTES

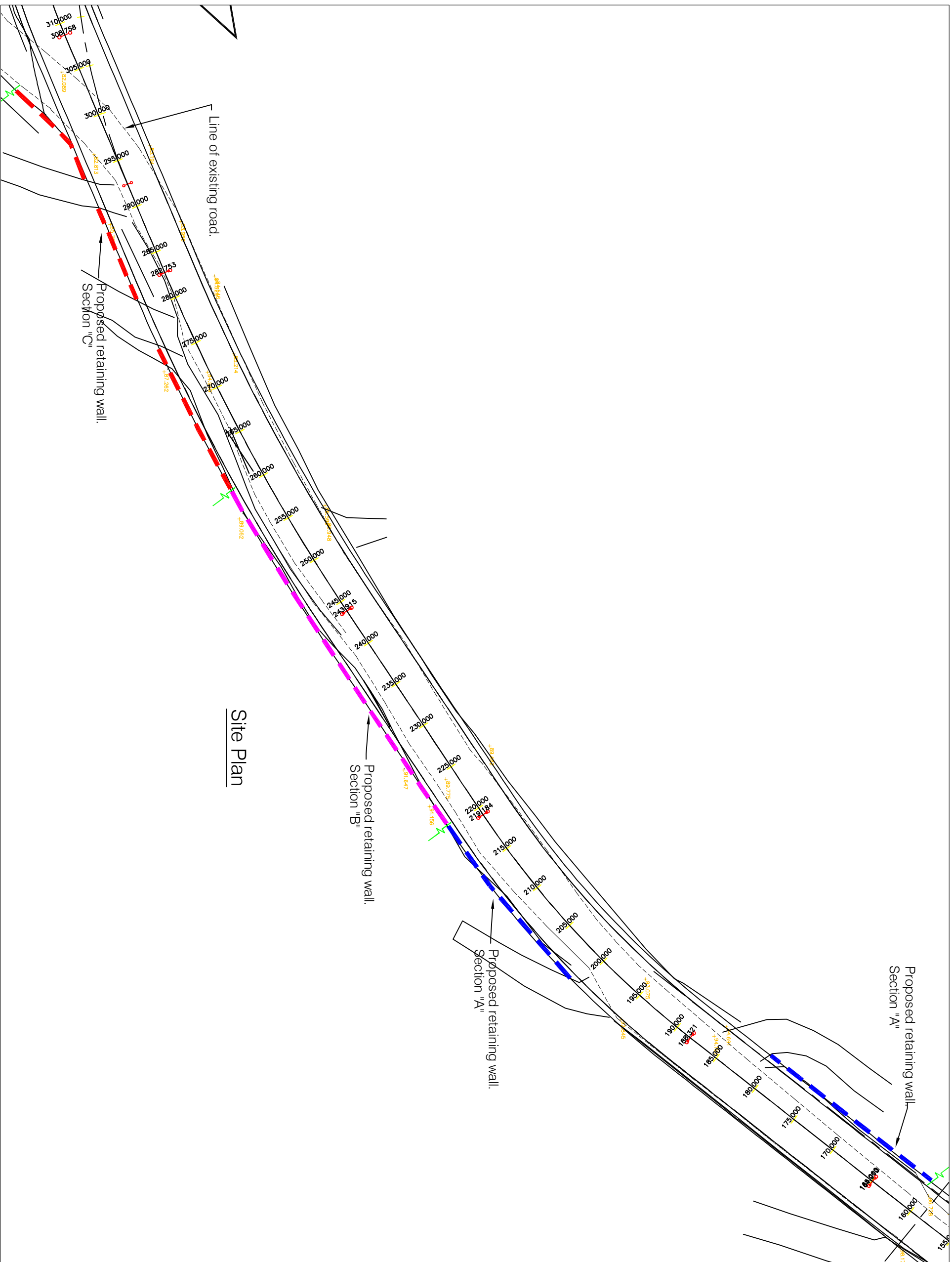

Site Plan

Public Works Department
 P.O. Box 344
 Mohiserrat
 West Indies
 Tel: 664- 491 -252/1/2
 Fax: 664- 491 -3475
 Email: gov_eng@candw.jr

PROJECT: BARZEY'S RETAINING WALL	
TITLE: SITE PLAN	
DESIGN: CP	JOB #: 0
DRAWN: CP	
CHECKED: PWD	
FILE PATH: 0	SHEET NO.: 01
DATE: 23/11/17	
SCALE: 0	

No.	Revision / Issue	By	Chk	Da